

Lbl	Qty	Member	Length	W(lb)
B0	2	362S162-43	2'-5 23/256"	1.222
J0	6	362S162-43	2'-5 23/256"	1.222
T0	1	362T125-43	8'-11 3/8"	4.382
T1	1	362T125-43	8'-11 3/8"	4.383

8 Bill of Material
1/4" = 1'-0"

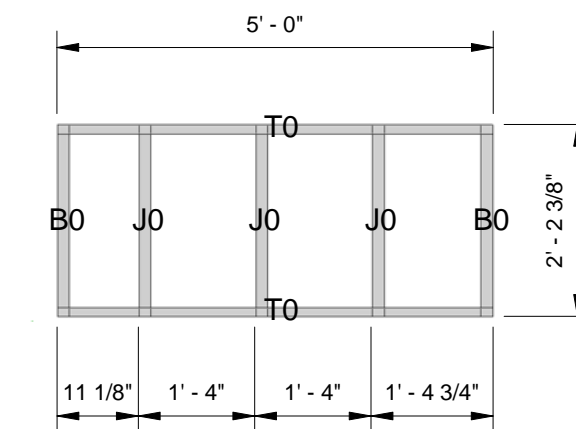
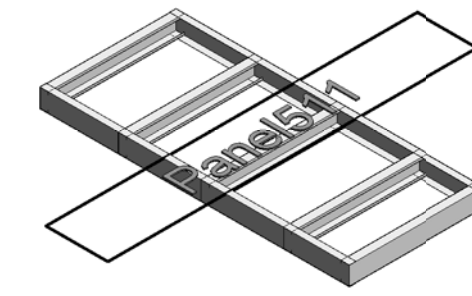

Lbl	Qty	Member	Length	W(lb)
B0	2	362S162-43	2'-2 39/128"	1.076
J0	3	362S162-43	2'-2 39/128"	1.076
T0	2	362T125-43	5'-0"	2.455

9 Bill of Material
1/4" = 1'-0"

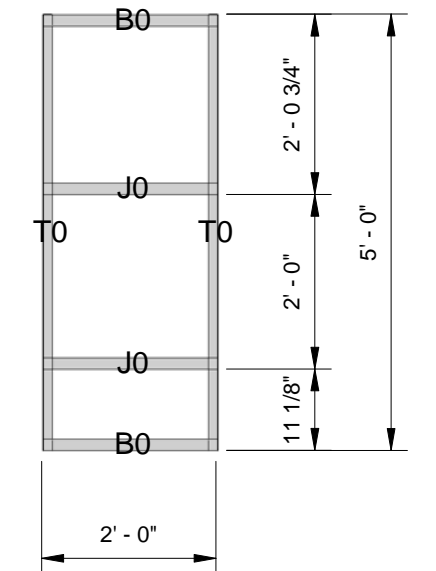
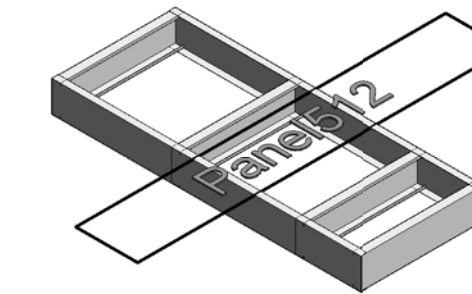

Lbl	Qty	Member	Length	W(lb)
B0	2	362S162-43	2'-5 23/256"	1.224
B1	1	362S162-43	2'-2 238/256"	1.102
B2	1	362S162-43	2'-0"	1.228
J0	7	362S162-43	2'-5 23/256"	1.224
J1	3	362S162-43	2'-2 238/256"	1.102
J2	4	362S162-43	2'-0"	1.228
T0	2	362T125-43	9'-0 7/128"	4.421

10 Bill of Material
1/4" = 1'-0"

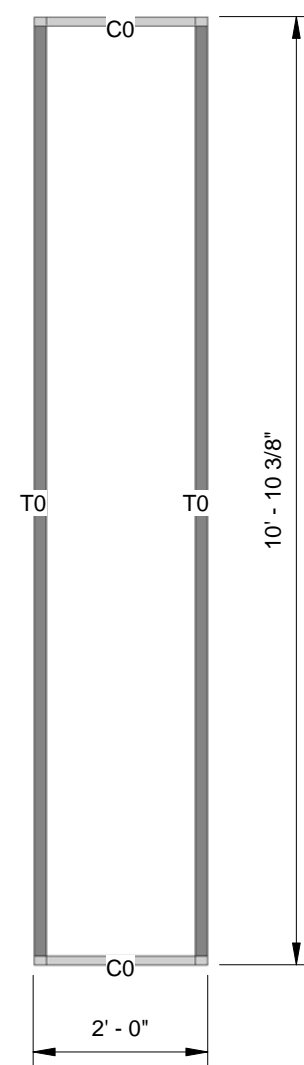

Lbl	Qty	Member	Length	W(lb)
C0	4	600T125-54	2'-0"	0.982
T0	4	600S162-54	10'-10 1/4"	5.329

23 Bill of Material
3/8" = 1'-0"

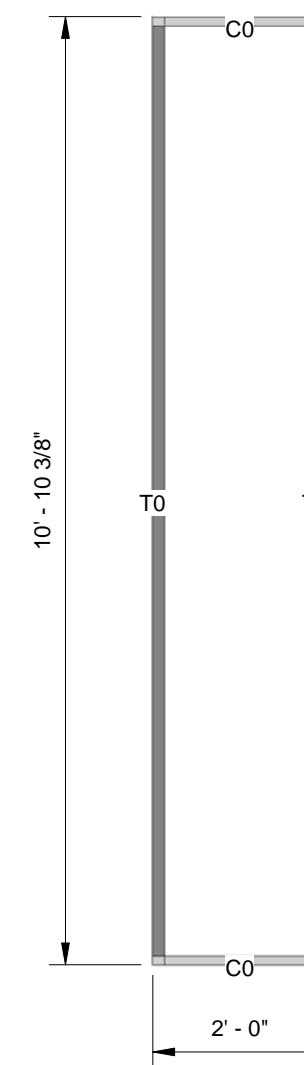
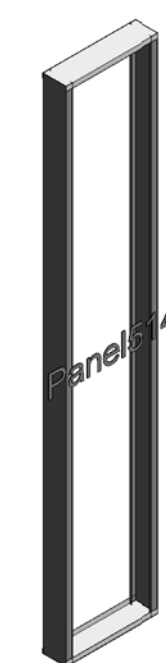

Lbl	Qty	Member	Length	W(lb)
C0	4	600T125-54	2'-0"	0.982
T0	4	600S162-54	10'-10 1/4"	5.329

26 Bill of Material
3/8" = 1'-0"

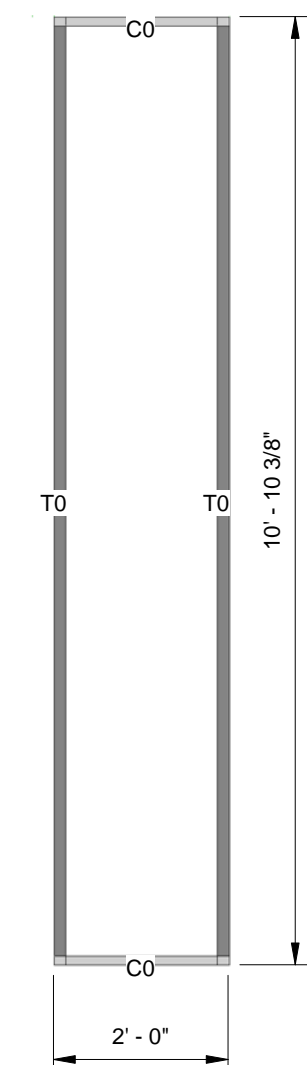

Lbl	Qty	Member	Length	W(lb)
C0	4	600T125-54	2'-0"	0.982
T0	4	600S162-54	10'-10 1/4"	5.329

24 Bill of Material
3/8" = 1'-0"

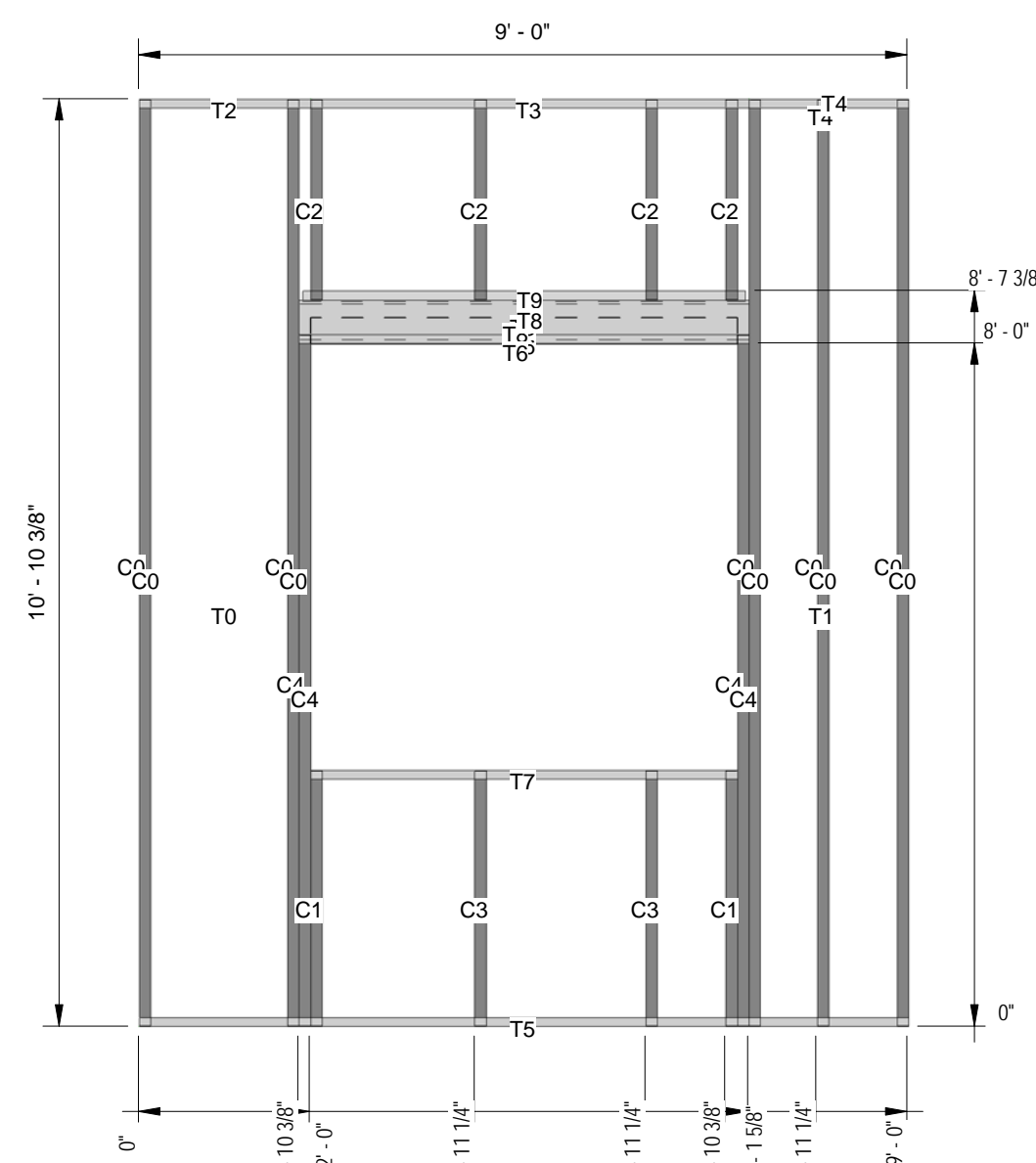
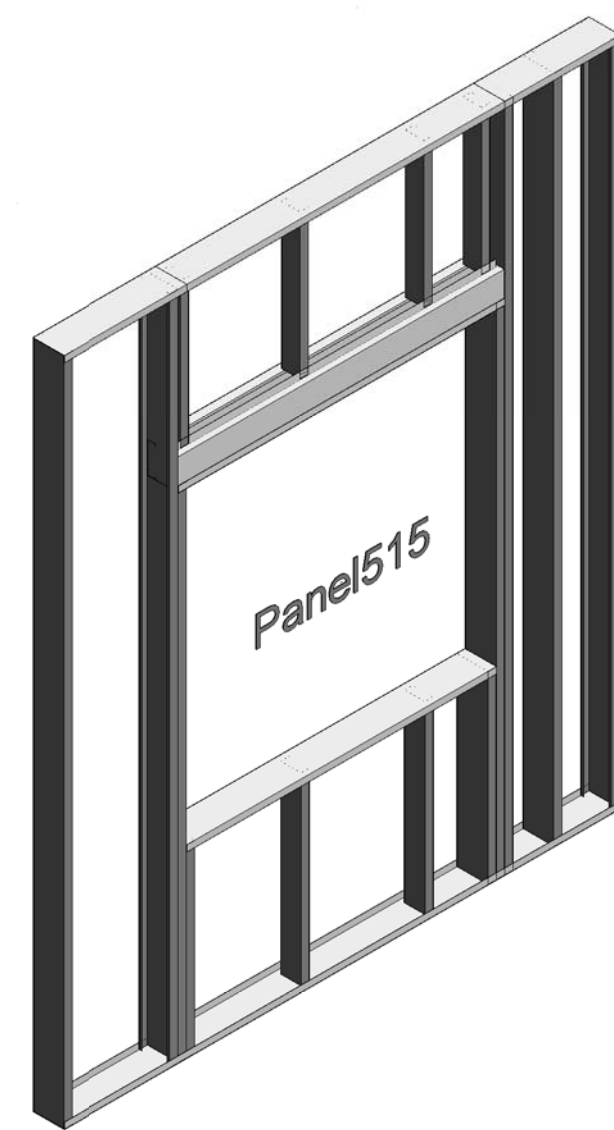

Lbl	Qty	Member	Length	W(lb)
C0	10	600S162-54	10'-10 1/8"	5.324
C1	4	600S162-54	2'-11 3/4"	1.463
C2	8	362S162-43	2'-4 1/8"	1.151
C3	4	400S162-54	2'-11 3/4"	1.463
C4	4	600S162-54	8'-1"	3.969
T0	1	150CRC-54	1'-11 3/4"	0.972
T1	1	150CRC-54	1'-11 3/4"	0.972
T2	2	600T125-54	2'-0"	0.982
T3	2	600T125-54	5'-1 5/8"	2.521
T4	2	600T125-54	1'-10 3/8"	0.916
T5	2	600T125-54	9'-0"	4.419
T6	2	600T125-54	5'-3 1/4"	2.588
T7	2	600T125-54	5'-0"	2.455
T8	4	600S162-54	5'-3 1/4"	2.588
T9	2	150L150-43	5'-3 1/4"	2.588

21 Bill of Material
3/8" = 1'-0"

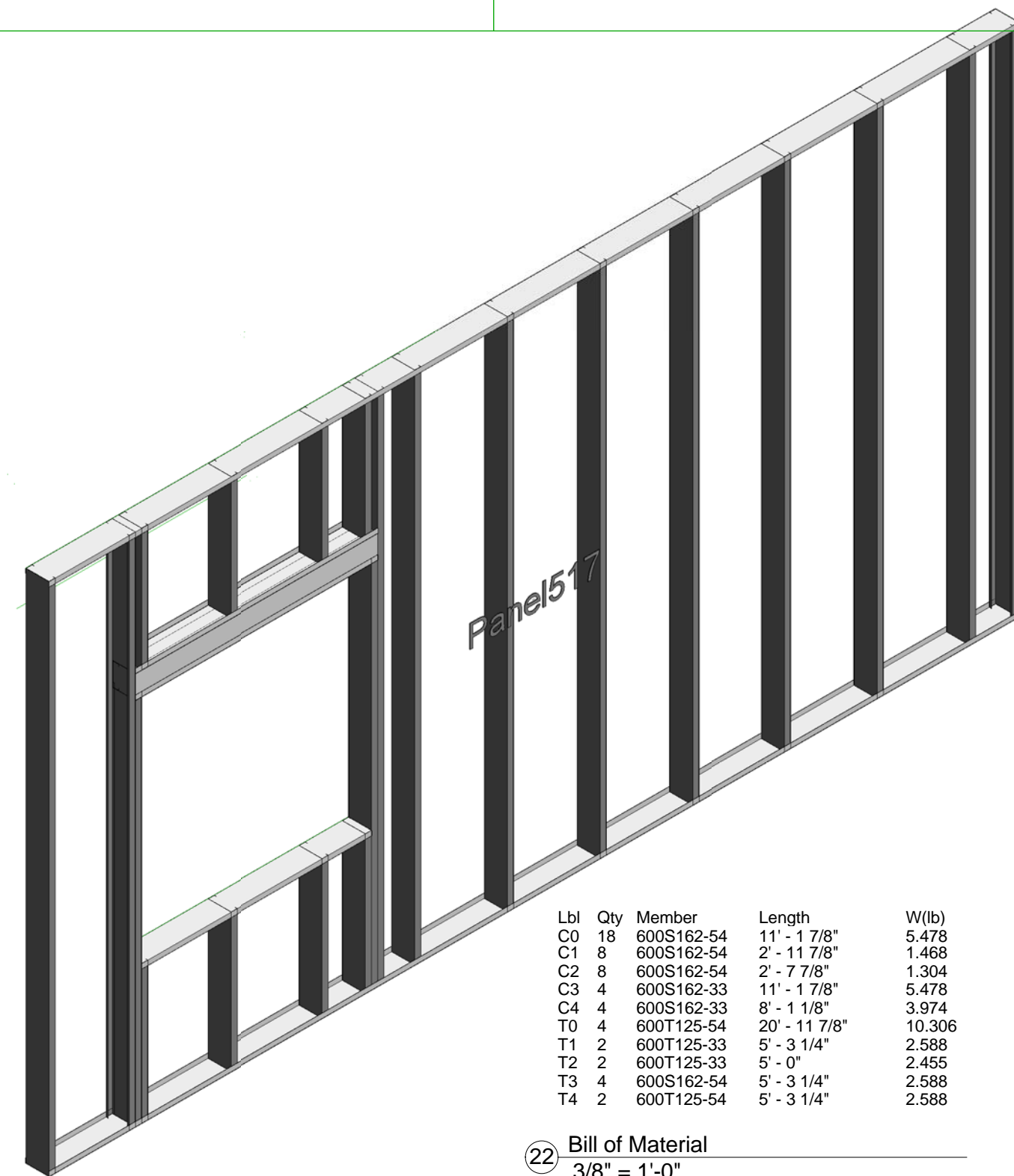

Lbl	Qty	Member	Length	W(lb)
C0	18	600S162-54	11'-1 7/8"	5.478
C1	8	600S162-54	2'-11 7/8"	1.466
C2	8	600S162-54	2'-7 7/8"	1.304
C3	4	600S162-33	11'-1 7/8"	5.478
C4	4	600S162-33	8'-1 1/8"	3.974
T0	4	600T125-54	20'-11 7/8"	10.306
T1	2	600T125-33	5'-3 1/4"	2.588
T2	2	600T125-33	5'-0"	2.455
T3	4	600S162-54	5'-3 1/4"	2.588
T4	2	600T125-54	5'-3 1/4"	2.588

22 Bill of Material
3/8" = 1'-0"

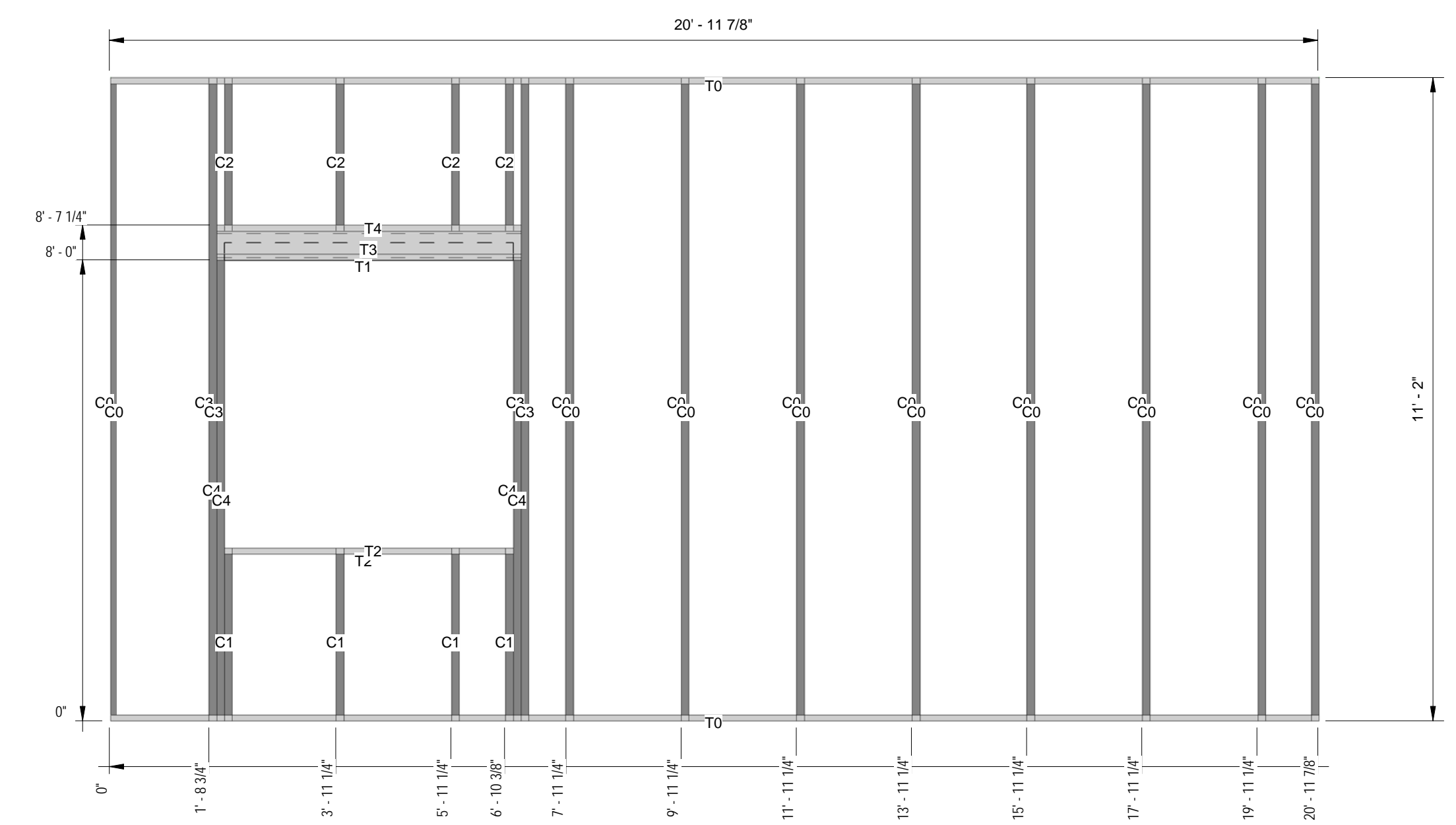

TRANSCON STEEL
FRAMING THE FUTURE
2200 S. Church Street
Georgetown, TX 78627
512-930-0066 office
512-930-0061 fax
www.TransconSteel.com
Support@TransconSteel.com

Review		Riverview at Gretna		5th Floor Balcony Panels 510-517			THE DRAWINGS HEREIN ARE MANUFACTURING DRAWINGS ONLY. CONTRACTOR SHALL BE SOLELY RESPONSIBLE FOR VERIFYING ALL DIMENSIONS, SITE CONDITIONS, AND THAT ALL STATE AND LOCAL CODE REQUIREMENTS ARE MET. PLEASE CONTACT TRANSCON STEEL FOR ANY ADDITIONAL CLARITY IN NEEDED PRIOR TO INSTALLATION. TRANSCON IS NOT RESPONSIBLE FOR ANY COSTS ASSOCIATED TO MATERIALS OR LABOR FOR THE REPAIR OR MODIFICATION OF FRAMING ASSEMBLIES.
Drawn by	Scale	Date	Size	Project number	Drawing number		
Author	As indicated	07/07/12	A	11-107	5.3		